



SEATTLE - JAN. 13-15, 2017
TACOMA - MAR. 3-5, 2017

YOU'RE INVITED!

Jump-start Your Business in 2017 at the Upscale Seattle & Tacoma Remodeling Expos!

Looking for the perfect way to jump-start your business in 2017? Then be sure to exhibit your home improvement solutions to thousands of focused and motivated homeowners at the upscale Seattle & Tacoma Remodeling Expos!

“MUST ATTEND” EVENTS

Produced by L&L Exhibition Management, the Seattle & Tacoma Remodeling Expos are timed to help you generate key projects and new customers for the 2017 selling season.

UPSCALE ENVIRONMENTS

The Remodeling Expo in Seattle, WA, will take place January 13, 14 & 15, 2017 at the Washington State Convention Center. The Tacoma Remodeling Expo will take place March 3, 4 & 5, 2017 at the Greater Tacoma Convention & Trade Center. For three days each, these upscale venues provide an ideal setting to connect with affluent homeowners planning for the year ahead.

As an exhibitor, you can look forward to:

- ▶ Generating quality leads from a pool of focused and highly motivated homeowners
- ▶ Meeting homeowners with a strong interest in home improvement, face-to-face
- ▶ Taking your place among the region's top home and garden professionals
- ▶ Showcasing your products in a quality trade show environment
- ▶ Building valuable and profitable relationships with industry partners and peers

Quite simply, the Seattle & Tacoma Remodeling Expos are must-attend events for home improvement professionals in the Seattle, Tacoma and surrounding areas.

COMPREHENSIVE ADVERTISING COVERAGE

To spread the word and attract homeowners who are looking for solutions that you offer, the Remodeling Expos will be aggressively advertised via TV, newspaper, online and radio, including: KOMO/KVI-AM, KRWM/KIXI, KZOK-FM, KMPS-FM, KJR-FM, KCMC-CM, KOMO, KING, KIRO, and cable stations.

PROFESSIONAL & PROVEN MANAGEMENT

Now in our 23rd year, L&L Exhibition Management is renowned across the country for producing high-profile, high-traffic events that showcase leading home improvement professionals and firms as well as the latest and most innovative products in the home improvement and home building industries.

RESERVE YOUR SPOT TODAY

Don't miss out on your chance to make profitable connections with focused and motivated homeowners in the Seattle and Tacoma home improvement markets. Reserve your spot today, and get ready to jump-start your business in 2017 and rapidly kick your sales into high gear!



L&L EXHIBITION MANAGEMENT INC.
7809 Southtown Center #200
Bloomington, MN 55431
www.homeshowcenter.com

Booths in grey shaded area need to move in after 2:00PM on Thursday and move out first Sunday night.
 All booths must be moved out by 12am Sunday night.



REMODELING EXPO 2017

JANUARY 13-15, 2017

Washington State Convention Center
 at convention place

Show Hours

Friday 12pm - 7pm
 Saturday 10am - 7pm
 Sunday 11am - 7pm

Exhibit Space Rates

- Local & WA Companies:
 1st & 2nd booth - \$1290* / 10'X10'
 3rd booth & up - \$1190* / 10'X10'
 - National/Direct Sale Companies:
 10' x 10' booth - \$1290*
- *add \$200 per corner booth.

All booths must be carpeted or have other suitable floor covering. No helium balloons.

Exhibit Space Includes

3' high x 10' wide drapery side walls
 8' high x 10' wide drapery back wall

Move-In Hours

ZONE 1 - Wednesday 10am
 ZONE 2 - Wednesday 12pm
 ZONE 3 - Wednesday 2pm
 Thursday 8am-4pm

Sunday Only Move-Out Hours

Sunday 7pm - 12am*
 *Please Note: Loading docks will not be available until 7pm
 *For 2017 all booths must be moved out by 12am Sunday night.

You Tube Click here to watch the video!



L&L EXHIBITION MANAGEMENT, INC.
 7809 Southtown Center #200
 Bloomington, MN 55431

For more information, call
1-800-374-6463
www.HomeShowCenter.com



REMODELING EXPO

Generate More Leads. Close More Sales.

MARCH 3-5, 2017

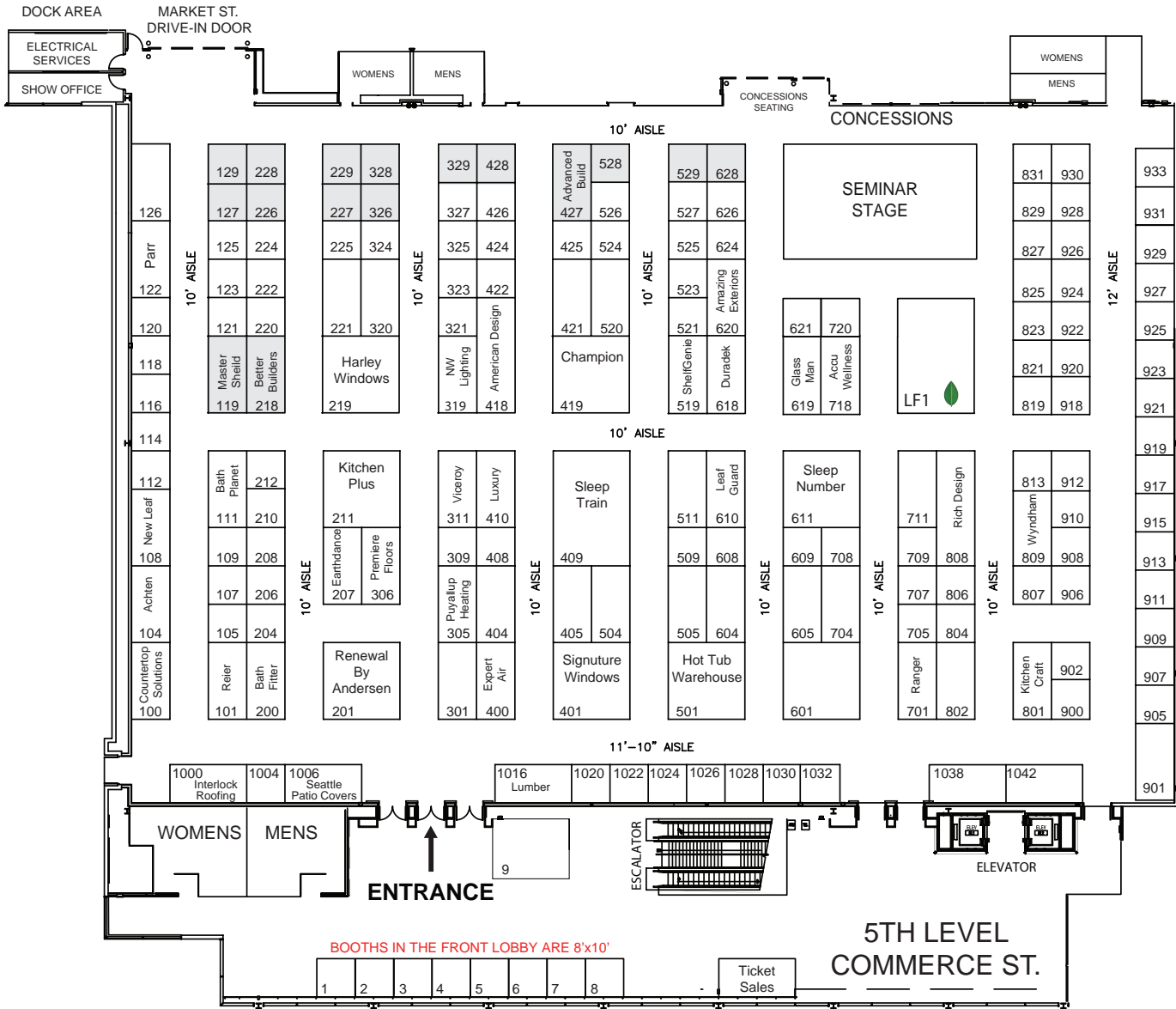

FRONT LOBBY IS CARPETED. NO DRIVE-IN, HAND CART OR CARRY ONLY.

Show Hours

Friday 12pm - 7pm
 Saturday 10am - 7pm
 Sunday 11am - 5pm

Move-In Hours

Wednesday 2pm - 6pm
 Thursday 8am - 4pm

Move-Out Hours

Sunday 5pm - 9pm
 Monday 8am - 1pm

Exhibit Space Rates

• Local & WA Companies:
 1st & 2nd booth - \$1150* / 10'X10'
 3rd booth & up - \$990* / 10'X10'

• National & Direct Sale Companies:
 \$1,150* / Booth

*add \$200 per corner booth.
 All booths must be carpeted or have other suitable floor covering

■ Shaded booths move in after 2:00PM on Thursday and move out first Sunday night.



Click here to watch the video!

Exhibit Space Includes

3' high x 10' wide drapery side walls
 8' high x 10' wide drapery back wall



L&L EXHIBITION MANAGEMENT, INC.
 7809 Southtown Center #200
 Bloomington, MN 55431

For More Info Call:
1-800-374-6463

Greater Tacoma Convention & Trade Center



L&L SHOW CONTRACT AND SPACE APPLICATION

Mail application and deposit to address below.
To ensure placement in the show call: 800-374-6463.
Fax: 952-881-4272 | www.homeshowcenter.com

SHOW	DATE	BOOTH(S) REQUESTED
<input type="checkbox"/> Northwest Remodeling Expo Washington State Convention Center	January 13-15 , 2017	_____
<input type="checkbox"/> Tacoma Remodeling Expo Greater Tacoma Convention & Trade Center	March 3-5 , 2017	_____

EXHIBITOR

Company Name: _____

Address: _____

City: _____ State: _____ Zip: _____

Phone: _____ Fax: _____ E-mail: _____

Products or services to be exhibited (please describe):

LOCATION ASSIGNMENT: Floor plan is subject to any modification if L&L Exhibition Management deems it necessary for the overall good of the Show or if the floor plan has minor variations.

PLEASE INCLUDE DEPOSIT AND MAIL APPLICATION TO:

L&L Exhibition Management
7809 Southtown Center #200
Bloomington, MN 55431

YES - I WOULD LIKE TO RECEIVE INFORMATION REGARDING:

- Program Advertising
- Speaking Opportunities
- Sponsorship

DEPOSIT AND PAYMENT TERMS: Minimum non-refundable deposit of FIFTY PERCENT of the exhibit space rental fee to be submitted with this application within 7 business days of reservation. The remaining balance is due thirty days prior to the show.

THE INDIVIDUAL SIGNING THIS CONTRACT WARRANTS THAT HE OR SHE HAS BEEN DULY AUTHORIZED TO EXECUTE THIS BINDING CONTRACT ON BEHALF OF THE ABOVE NAMED EXHIBITOR. THIS CONTRACT AND SHOW RULES AND REGULATIONS WILL CONSTITUTE ENTIRE AGREEMENT BETWEEN L&L EXHIBITION MANAGEMENT AND EXHIBITOR.

EXHIBITOR (Company Name):

Authorized Signature

DATE:

Print Name and Title



SHOW RULES AND REGULATIONS

Phone: 800-374-6463

Fax: 952-881-4272

www.homeshowcenter.com

EXHIBIT SERVICE INFORMATION

Exhibitor agrees to be bound by the rules and regulations as may be established by the show decorator and to abide by all applicable rules as set forth in the contracts of labor unions whose jurisdictions apply to this exhibition in this facility.

REMOVAL TIME

Dismantling may not begin until show closing on Sunday of the show and all exhibits must be removed by the specified time on your floor plan. Exhibit materials not removed by this time will be removed by the decorator and put in storage at Exhibitor's expense. Hours of installation and dismantling are subject to change by L&L Exhibition Management.

EXHIBIT HOURS

L&L Exhibition Management reserves the right to change exhibit hours and/or change the number of days or dates of the Exhibition as it may deem desirable. L&L Exhibition must hold any rescheduled event within 13 months of originally contracted event or refund all monies.

USE OF EXHIBIT

All demonstrations or other promotional activities must be confined to the limits of the exhibit space. Sufficient space must be provided within the exhibit space for the comfort and safety of persons watching demonstrations and other promotional activities. Each Exhibitor is responsible for keeping the aisles near its space free of congestion, caused by demonstrations or other promotions. Exhibitor shall not assign, sublet, or share the space allotted without the knowledge and written consent of L&L Exhibition Management. No firm or organization not contracted directly with L&L Exhibition Management will be permitted to solicit business within the exhibit area.

L&L Exhibition Management reserves the right to restrict exhibits which, because of noise, method of operation, materials or any other reason become objectionable, and also to prohibit or remove any exhibit which, in the opinion of L&L Exhibition Management, may detract from the general character of the Show. This reservation includes persons, things, conduct, printed matter, or anything of a character which L&L Exhibition Management determines is objectionable. In the event of such restriction or removal, L&L Exhibition Management shall not be liable for any refunds or other exhibit expenses.

TAXES AND LICENSES

Exhibitor shall be responsible for obtaining any licenses, permits or approvals, required under local or state law applicable to their activity at the Show. Exhibitor shall be responsible for obtaining any tax identification numbers and paying all taxes, license fees or other charges that shall become due to any governmental authority in connection with their activity at the Show.

EXHIBIT SAFETY

For all exhibits over 8 feet high, the Exhibitor hereby represents and warrants to L&L Exhibition Management that exhibitor has taken all steps reasonably necessary to ensure the sound engineering and structural integrity of its exhibit design and the proper construction and safety of the exhibit itself, as erected, including obtaining the certificate of a registered structural engineer if reasonably available. Exhibitor accepts responsibility for any personal or property damage that may result directly or indirectly from the collapse of its exhibit or any portion thereof or the existence of any other unsafe condition at the exhibit. Exhibitor hereby agrees to indemnify and hold harmless L&L Exhibition Management, the owner and management of the exhibition facility, and others lawfully on the exhibit floor, from and against any claim, loss liability or damage as a result of Exhibitor's construction or maintenance of an unsafe exhibit, and Exhibitor further represents and warrants that it has obtained adequate insurance to cover its potential liability hereunder. Exhibitor shall furnish L&L Exhibition Management with the engineering and/or insurance certificates referred to herein upon request prior to or during the Show.

LIABILITY

Neither L&L Exhibition Management, nor its agents or representatives, will be responsible for any injury, loss or damage that may occur to the Exhibitor or to the Exhibitor's employees or property from any cause whatsoever. Under no circumstance will L&L Exhibition Management be responsible for lost profits or other incidental or consequential damages. Exhibitor shall obtain, at its own expense, adequate insurance against such injury, loss, or damage. L&L Exhibition Management shall not be liable for failure to perform its obligations under this contract as a result of strikes, riots, acts of God, or any other cause beyond its control. Anyone visiting, viewing or otherwise participating in the Exhibitor's exhibit is deemed to be the invitee or licensee of the Exhibitor, rather than the invitee or licensee of L&L Exhibition Management. L&L Exhibition Management shall not be liable for any injury whatsoever to property of the Exhibitor or to persons conducting or otherwise participating in the conduct of the exhibit or to invitees or guests of the Exhibitor. Exhibitor agrees to abide by existing agreements and regulations covering the use of services or labor in the conference and exhibit facility. The Exhibitor assumes full responsibility and liability for the actions of its agents, employees, or independent contractors, whether acting within or without the scope of their authority and agree to save harmless L&L Exhibition Management and the exhibit hall from responsibility or liability resulting directly or indirectly, or jointly, from other causes which arise because of the actions or omissions of its agents, employees, or independent contractors, whether acting within or without scope of authority. There is no other agreement or warranty between the Exhibitor and L&L Management except as set forth in this document. The rights of L&L Exhibition Management under this contract shall not be deemed waived except as specifically stated in writing and signed by an authorized officer of L&L Exhibition Management.

SECURITY AND INSURANCE

The exhibitor is solely and fully responsible for its own exhibit material and should insure its exhibit against loss or damage from any cause whatsoever. All Property of an exhibitor is understood to remain in its care, custody and control in transit to or from or within the confines of the Exhibit Hall.

CARE OF BUILDING AND EQUIPMENT

Exhibitors or agents, must not injure or deface the walls or floors of the building, the exhibit spaces, or the equipment of the exhibit spaces. When such damage appears, the exhibitor is liable to the owner of such property so damaged. All materials used in decorations must be flameproofed. Electrical wiring must conform with the National Electric Code Safety rules and all other applicable rules, regulations, fire laws, electrical codes and other laws of the city in which the Show is located, and of any other government authority maintaining jurisdiction over the said exhibition facility, which affect the installation, conduct and disassembly of the exhibit. Combustible materials or explosives are not permitted in the Exhibit Hall. The Exhibitor shall also comply with all reasonable requests of officials of the Exhibit Hall and L&L Exhibition Management with respect to the installation, conduct and disassembly of its exhibit.

Initial: _____

Date: _____